

PANEL CUT-OUT

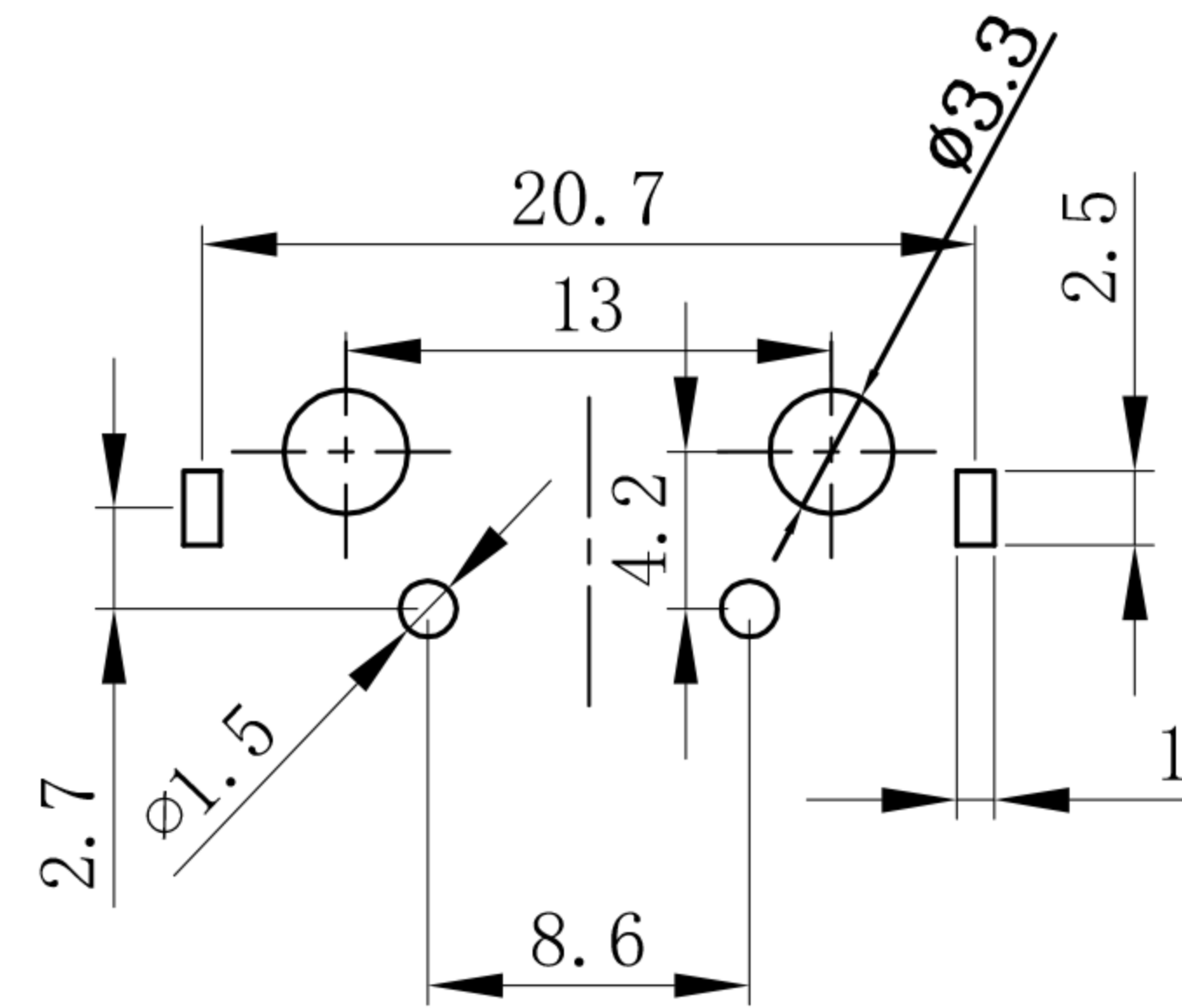
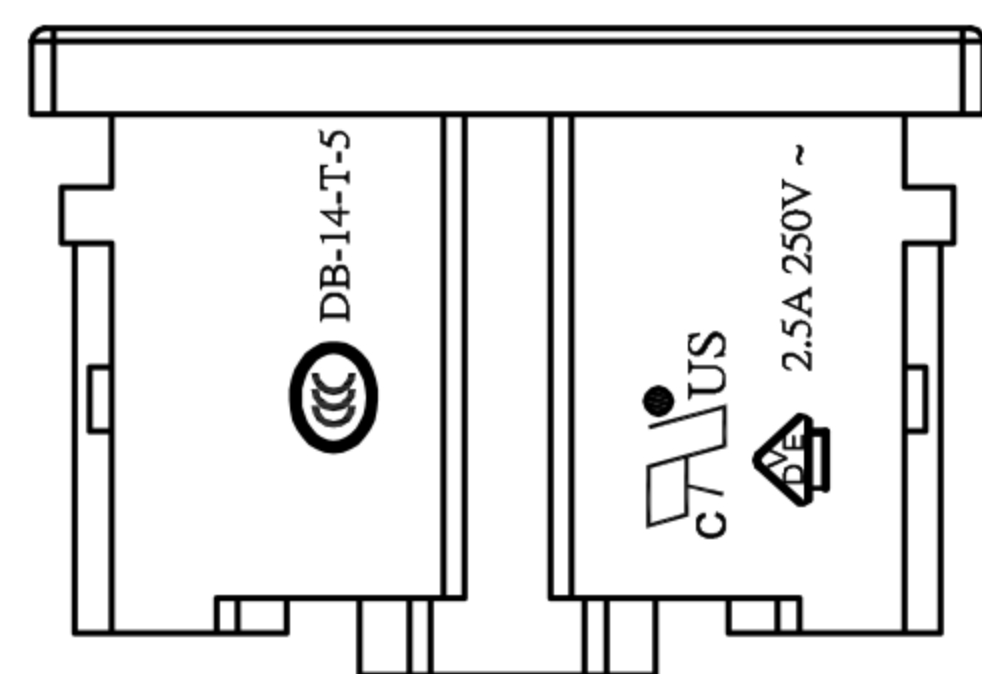

PCB LAYOUT

产品类型特性

- 1. AC插座 材质
- 2. 塑胶件 PA66
- 3. 插销 黄铜镀镍
- 4. 端子 黄铜镀锡
- 1. 使用温度范围:  $-10^{\circ}\text{C} \pm 70^{\circ}\text{C}$
- 2. 额定值: 2.5A/5A/7A AC 125V 250V AC
- 3. 绝缘电阻:  $100\text{M}\Omega$
- 4. 耐电压: 2500V AC
- 5. 接触电阻:  $30\text{M}\Omega$
- 6. 寿命: 10000次
- 结构特性 插拔力:  $13.6\text{N} \sim 68\text{N}$
- 端子强度: 60N
- 盐雾测试:  $35 \pm 2^{\circ}\text{C}$  24/h
- 耐环境性能 耐寒性能  $-20 \pm 2^{\circ}\text{C}$  96/h
- 耐热性能  $100 \pm 2^{\circ}\text{C}$  96/h
- 耐湿性能  $40 \pm 2^{\circ}\text{C}$  相对湿度90~95% 96/h

 东莞市高迪电子有限公司  
DONG GUAN GAO DI ELECTRONICS CO., LTD

TOLERANCE UNLESS OTHERWISE STATED:  
 Up to 5 ±0.2  
 Above 5 ~ 15 ±0.3  
 Above 15 ~ 30 ±0.4  
 Above 30 ~ 50 ±0.5  
 Angle ±0.3°

3RD. ANGEL'S

UNITS MM

DRAWN BY: Ming Ming Zou  
 DATE: 10/31/13

CHECKED BY: Ning Ning Su  
 DATE: 10/31/13

APPROVED BY: Jia Xiang  
 DATE: 10/31/13

MAT'L	TITLE	SWITCH
FINISH	MODLE	AC POWER SOCKET
SCALE 1:1	DWG NO.	GD-DB-14-T-20A
SHEET NO. 1 of 1	PART NO.	

ITEM NO.	DESCRIPTION	DRAWN	DATE

SIZE A4  
 VER R